

LT210 – Ride Height and Track Temperature Sensor



The LT210 is a combination time of flight distance measurement sensor and infrared track temperature sensor. It is ideally suited for ride height measurement applications where getting the most data is paramount. Standard distance measurement ranges of 0-40” and 0-80” mean that even large wheel stands, or jumps can be accurately measured. High ambient light immunity means that even measuring in direct sunlight is not an issue. Track temperatures of 32-212°F (0-100°C) are measured with an integrated infrared temperature sensor mounted in the LT210 enclosure. Using a standard M12 connector the LT210 can be powered with 5-36V and provides a 0-5V outputs to interface with the vehicle ECU or data logger. Standard distance output ranges of 0-40” and 0-80” are available.

Item	Value	Units
Supply Voltage	5-36	Volts
Supply Current	<200	mA
Distance Output Signal	0-5	Volts
Distance Sensing Range	0-39.4	Inches
Temperature Output Signal	0-5	Volts
Temperature Sensing Range	32-212	Fahrenheit
Suggested Sample Frequency	>100	Hz
Mounting Screw	#8-32	-

Notes:

- Distance output is linear 0-5V to 0-39.4inches (0-100cm). At 4.8V (37.8inches) unit will clip output.
- Temperature output is linear 0-5V to 32-212°F (0-100°C).
- The status LED on top of the unit, and the output voltage will operate as following:
 - On power up LED will flash orange and then go solid blue.
 - Normal operation: solid blue LED, output voltage 0-5V linear with distance.
 - Error from inability to detect surface or out of range: solid orange LED, output voltage 5V.
 - Low supply voltage: continuously alternating orange/blue LED, output voltage 0V.
- If unit is unable to detect a highly reflective surface, it may be beneficial to angle the unit slightly relative to the surface, rather than perpendicular.
- Distance sensor lens material is acrylic. Do not use acetone, brake cleaner, etc. to clean as this will damage the lens and affect sensor performance. Clean distance sensor and temperature sensor lenses with microfiber or other soft cloth to keep dirt and debris from affecting performance.
- Distance sensor has blind zone of approximately 4 Inches. This means that objects closer than this cannot be measured accurately.
- Infrared temperature sensor has a field of view of approximately 10°.
- It is recommended but not necessary to mount sensor with logo on the sensor mounted fore-aft. i.e. Logo on sensor body pointed forward or backward on the car.
- Removable thread locking compound on the mounting hardware is generally a good idea, especially in high vibration environments.

Pinout as viewed from top of sensor:

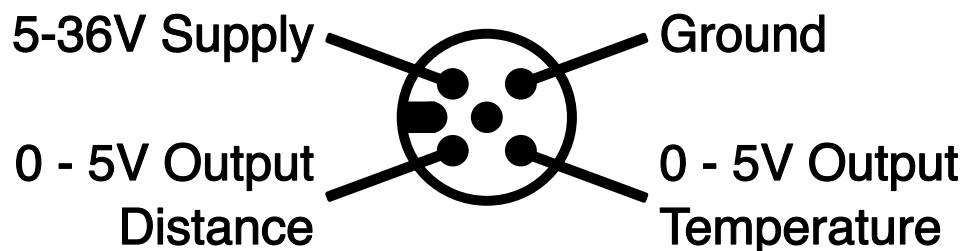

5-36V Supply - Brown

0-5V Output - Distance - White

0-5V Output - Temperature - Blue

Ground - Black

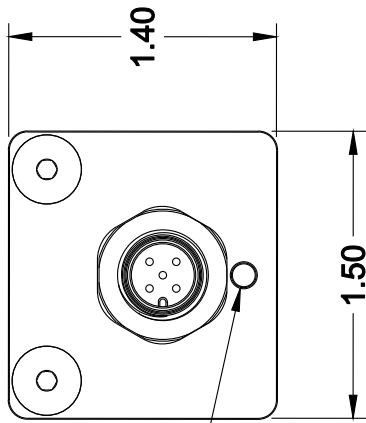

BLUE-ORANGE
STATUS LED

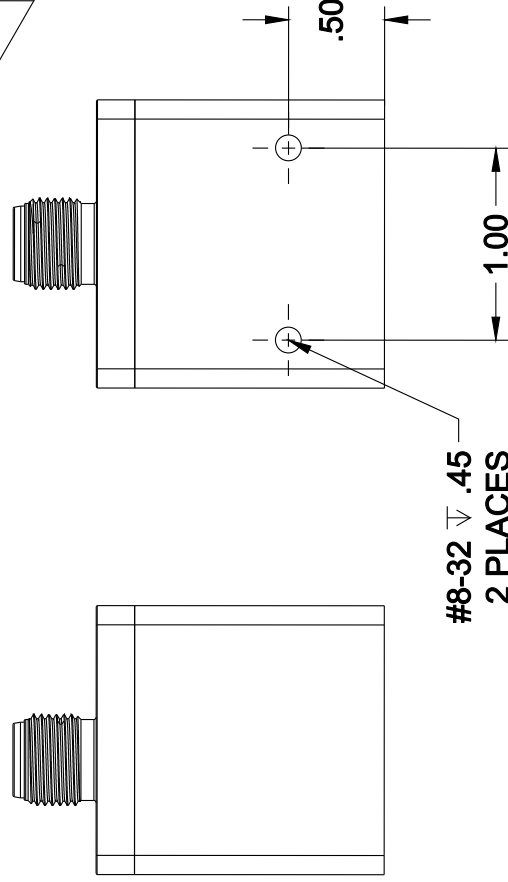
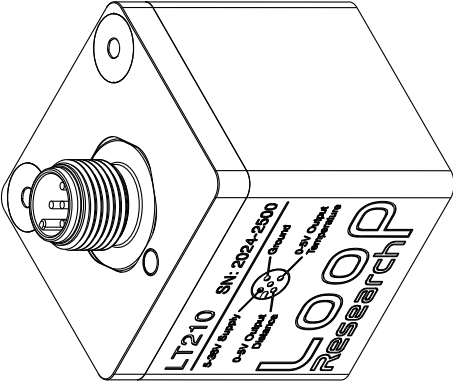
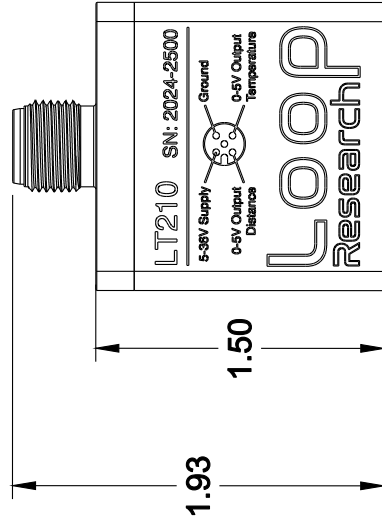

#8-32 ∇ .45
2 PLACES

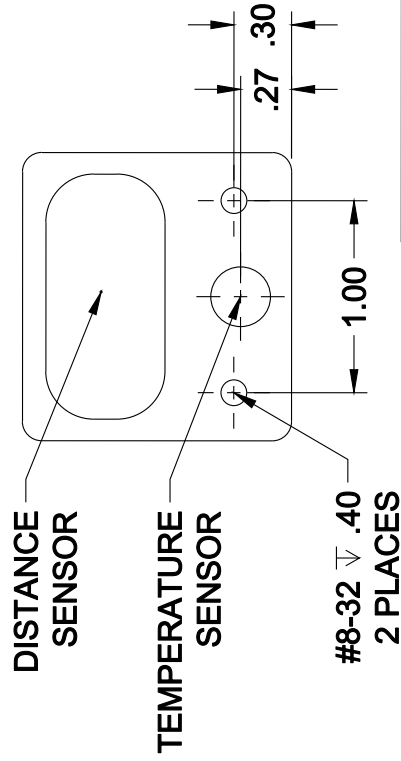

DISTANCE
SENSOR

TEMPERATURE
SENSOR

#8-32 ∇ .40
2 PLACES

LOOP
Research

Dimensions in Inches unless otherwise noted

LT210 Sensor Dimensions

July 15, 2024

1.0